



# A82 Inverness Walking & Cycling Improvements Tomnahurich Roundabout to Longman Road



## Issue Seven - September 2020

### Project Outline

Welcome to the seventh newsletter providing information and progress updates about the ongoing road safety improvements on the A82 between the Tomnahurich Roundabout and Longman Roundabout in Inverness.

The overall project aims to improve facilities for non-motorised users who use the A82. The project aims to provide pedestrians and cyclists with safer crossing points with an aim of reducing the number of vehicle collisions and encourage active travel in the area.

The project will be carried out by BEAR Scotland on behalf of Transport Scotland and will involve the following improvements:

- The installation of a push-button traffic signal controlled crossing over the A82 at Smith Avenue near to the Scotmid Shop which was completed in August and is operational;
- The installation of a push-button traffic signal controlled crossing over the A82 between Montague Row and Ardross Street. This work is due to commence in late September and take approximately two months to complete;
- The installation of an upgraded signal-controlled junction at Kenneth Street and Tomnahurich Street with the provision of additional pedestrian crossing facilities across all arms of the junction. To avoid having this extensive scheme underway in the run up to the busy Christmas and New Year holiday period, which may result in delays to motorists, it is currently planned to start in January 2021;
- The installation of kerbed buildouts at key locations of the footway and improvements to existing pedestrian islands and bus stops. This work is anticipated to begin in April 2021.
- A wide ranging investigation into potential NMU improvement options for the A82 Longman Road Dual Carriageway.

### What has happened since May?

#### Smith Avenue

Unfortunately, due to the Covid-19 Pandemic and restrictions to working on the road network all non-essential works were paused between March and June 2020. The restrictions limited the construction works which would be carried out on this scheme and therefore extended the delivery time for all sections of this scheme, we apologise for any inconvenience this caused.

Since the lifting of the lockdown restrictions in June 2020 the signal-controlled pedestrian crossing at Smith Avenue is now operational and is frequently used by pedestrians. The signal-controlled crossing is now awaiting the installation of the NeateBox technology (please see next page for details).

*The commission of the controlled crossing at Smith Avenue to be operational was featured in the Inverness Courier.*



*"We are delighted to see the new crossing on Glenurquhart Road now operational – it is already making a big difference for local residents so please pass on our thanks to all involved" – Helen Smith, Chair of Ballfeary Community Council*



*Pedestrians using the operational controlled crossing over the A82 at Smith Avenue*

## What's Coming Up?

### Montague Row

The design for the signal-controlled crossing between Montague Row and Ardross Street has now been finalised and has entered the pre-construction phase. Due to vital works being carried out by Scottish Water to upgrade the water network near to Montague Row the delivery of the controlled crossing has been postponed slightly but the construction phase will be expected to start at the end of September and take six to eight weeks to be completed. This controlled crossing will also be fitted with the Neatebox technology.

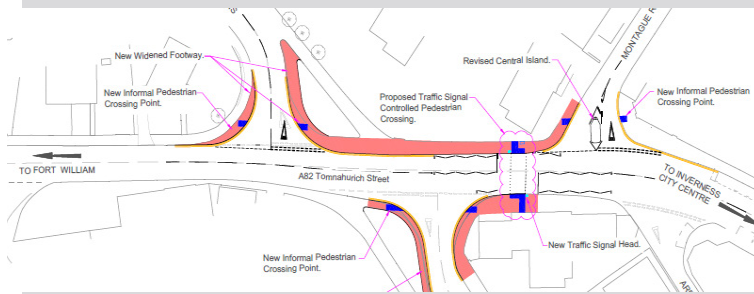

### Kenneth Street/Tomnahurich Street Junction

The recent traffic modelling exercise has revealed a preferred layout for the junction which has now been finalised by traffic signal specialists.

The layout for the Kenneth Street / Tomnahurich Street Junction has now entered its final design phase and will be expected to start construction around January 2021.

### Telford Roundabout to Longman Road Roundabout

A previous consultation carried out in August 2018 revealed that non-motorised users travel the A82 dual carriageway as a route for commuting daily to their place of work and supplemented by leisure users visiting retail premises. However, the feedback received identified they can experience significant difficulties using the route.

The main issues related to legal restrictions which prohibit cycling on the footway; delays when crossing busy roads and the lack of accessible and obvious routes to attractions and places of work. Since 2018 there have been several major developments constructed in the vicinity of the A82 and the Longman area of Inverness which are likely influence travel patterns, including vehicular traffic and further encourage demand for active travel facilities.

Following a review of the consultation feedback, investigation work is planned to commence this financial year to re-assess the previous proposals against the project's primary objective of casualty reduction and the incorporation of active travel facilities where appropriate.

## Why do we choose puffin crossings for the trunk road network?

There are multiple benefits of puffin crossings over more traditional crossings such as pelican and zebra crossings. Due to the multiple benefits of puffin crossings, which get their name from the acronym of being Pedestrian User-Friendly Intelligent crossings, makes them more suitable for the trunk road network and the preferred choice for these schemes. Puffin crossings are a more modern design that feature a pedestrian demand button and a signal box on the same side of the crossing – to the right-hand side of the pedestrian waiting area which is where pedestrians view approaching traffic. These crossings feature dropped kerbs which are flush with the carriageway and tactile paving to assist the mobility impaired, such as wheelchair users, to cross easily.

Puffin crossings are a more advanced design than the pelican crossing as they feature sensors which can detect if a pedestrian is waiting (and can cancel the demand signal if not required) which reduces the disruptions to traffic flow. The same technology can also detect if a pedestrian requires more time to cross the road and will hold the waiting vehicles on red for longer.

Puffin crossings can be combined with 'Neatebox' technology which allows pedestrians to virtually 'press the button' from their phones with an app called Button. In urban areas, not all puffin crossings will have an audible signal (as it can lead to confusion if there are multiple crossings close together) the Neatebox technology increases the usability of the crossing for those with visual impairments and other disabilities.

## Traffic Information

Once the Smith Avenue works are complete the construction of the pedestrian crossing at Montague Row will commence which will require temporary traffic lights, in operation between 9am-4am. These may be extended to ensure the safety of the Operations Team.

To report a defect or problem on the trunk road network, please visit the BEAR Scotland website at <http://bit.ly/ReportADefect> or contact the Trunk Road Customer Care line on 0800 028 1414.

Motorists driving in and around Inverness can access up to the minute journey time information at [www.trafficscotland.org](http://www.trafficscotland.org) or twitter [@traffscotland](https://twitter.com/traffscotland).

Should you require any further information about the A82 Tomnahurich Road Safety Improvements, please contact BEAR Scotland by emailing: [NWConsultation@bearsotland.co.uk](mailto:NWConsultation@bearsotland.co.uk) or call 0800 028 1414.

[www.bearsotland.com](http://www.bearsotland.com)

 BEAR Scotland

 @NWTrunkRoads

