



A82 Inverness Walking & Cycling Improvements

Tomnahurich Roundabout to Longman Road



Issue Three - November 2019

Project Outline

Welcome to the third newsletter which provides information and progress updates about the upcoming road safety improvements on the A82 between Tomnahurich Roundabout and Telford Roundabout in Inverness.

Since the previous update, great progress has been with the development of the project as teams have a confirmed month of when the first phase of project is set to get underway.

The £400,000 project will involve improvements to the facilities for non-motorised users on the A82 which will provide pedestrians and cyclists with safer crossing points as well as reducing the incidences of vehicles colliding with the existing traffic signal columns.

The project will be carried out by BEAR Scotland, on behalf of Transport Scotland and will involve the following improvements at the mentioned locations:

- The installation of a push-button controlled pedestrian crossing at Smith Avenue, near the Scotmid Shop.
- The installation of a push-button controlled crossing between Montague Row and Ardross Street.
- Upgrades to the traffic signal-controlled junction at Kenneth Street and Tomnahurich Street junction.
- The installation of kerbed buildouts at key locations and the improvement of current pedestrian islands.

What has happened since September?

Following the design stage, the Risk Assessments for the scheme have been carried out which ensure risks are mitigated throughout the construction phase, this allows the project to be completed in as short a time frame as possible.

A Walking, Cycling and Horse-riding assessment has been carried out and is being finalised. The best options have influenced the design drawings to include a number of NMU facilities which increase ease of access.

What's Coming Up?

Smith Avenue

The design team has finalised the drawings for Smith Avenue and construction is set to start in early January 2020. The project had been planned to commence in late November however due to the duration of this scheme (around four weeks), this would have resulted in delays to the travelling public as well as disruption to residents during the Festive period. By starting the project in January means there will be no disruption over the Christmas period and the contractors will then move straight onto the construction of the crossing point at Montague Row.



Montague Row

Montague Row is currently in the design phase. Consultation with stakeholders is ongoing for this location to ensure local residents are aware of the improvements and any potential disruptions. There will be discussion to ensure the projects do not have any significant impact on the emergency services, bus services and local businesses. Once this stage of the design phase has been completed then the project can be programmed for construction.

Tomnahurich Street / Kenneth Street Junction – Computer generated Image of junction using 3D software

The image below is a computer-generated model of the Tomnahurich Street/Kenneth Street junction. The image is generated from a 3D topographical survey of the A82 through Inverness which was undertaken earlier this year. This mobile survey is carried out by having electronic survey equipment mounted on the roof of a vehicle with data captured as the vehicle travels along the road. The benefits of this system are that the survey is quick, reliable and doesn't require surveyors to be on the road, which may require road closures or temporary traffic management. This means there is no impact to traffic on the A82. The output from the surveys allows our design team to investigate potential design solutions to improve the junction. The aims of the improvement at this junction is to improve crossing facilities for pedestrians and maximise throughput of the junction.



Telford Roundabout to Longman Road Roundabout

The current focus of the improvements to non-motorised user facilities is on the stretch of the A82 between Bught Drive and Telford Road Roundabout. The section of the A82 between Telford Road Roundabout and Longman Road Roundabout will be investigated in the future and further consultation with stakeholders will be carried out in due course.

Outline proposal drawings have been produced for the two signalised crossings at Smith Avenue and Montague Row as detailed below.

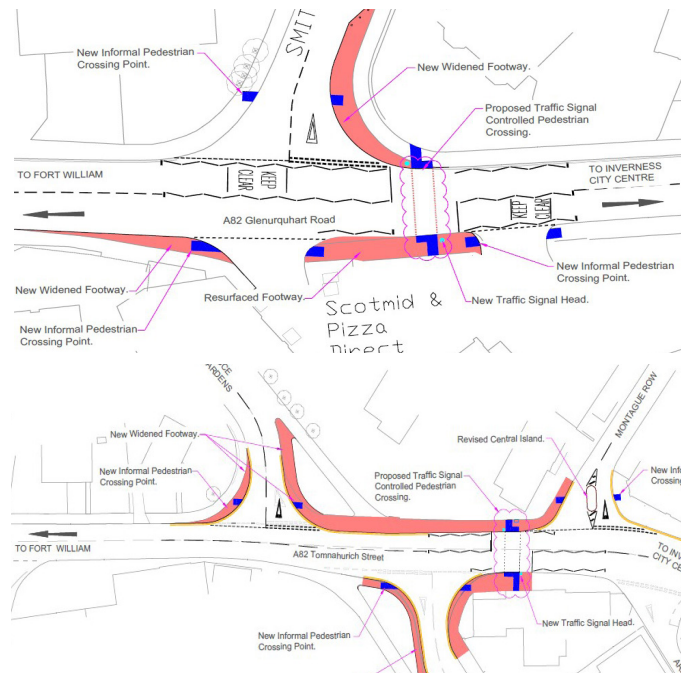

Traffic Information

During the construction period of the traffic signal-controlled crossing at Smith Avenue, there will be three-way traffic signals in place while the works are underway. Two of the temporary traffic lights will be in place on Glenurquhart Road with a further set on Smith Avenue. This is required to ensure the safety of road users during the construction phase. There will be temporary traffic lights in place for safety 24-hours a day, seven days a week whilst some of the construction works are underway. When deemed safe to do so the traffic lights will be removed to reduce the impact on the travelling public. We will aim to keep the travelling public updated as the scheme progresses.

Motorists driving in and around Inverness can access up to the minute journey time information at www.trafficscotland.org or twitter [@trafficscotland](https://twitter.com/trafficscotland).

Should you require any further information about the A82 Tomnahurich Road Safety Improvements, please contact BEAR Scotland by emailing: NWConsultation@bearsotland.co.uk or call 0800 028 1414.

www.bearsotland.co.uk

 BEAR Scotland

 @NWTrunkRoads

